



Product : Sewage treatment plant

Type : Oxyfix® FIXEUC90
 Model : C-90 MB 12 PE (2)
 Process : Submerged Aerated Fixed Film (SAFF) Technology

PERFORMANCE

Assumed Influent Values

Application :	Wastewater Treatment*	
Pollutant load BOD ₅ :	0.72	kg O ₂ /day
Pollutant load COD :	1.62	kg O ₂ /day
Pollutant load TSS :	1.08	kg/day
Hydraulic load :	1.80	m ³ /day

Purification performance

BOD ₅ :	< 25	mg O ₂ /liter
COD :	< 125	mg O ₂ /liter
TSS :	< 30	mg/liter

* We recommend placing a grease trap for treating waste water generated by a restaurant, kitchens used for commercial purposes, etc.

FEATURES

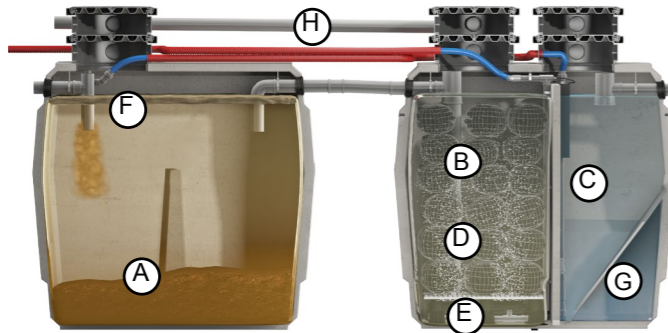

ELECTROMECHANICAL COMPONENTS

Blower

Quantity :	1	pc(s)
Type :	diaphragm blower	
Installed power :	0.09-0.10	kW
Power consumption :	0.08	kW
SPL (Sound Performance Lab) :	≤ 45	dB(A)
On / Off :	60/00	min.
Voltage :	1x230V	

Air Diffusers

Quantity :	4	pc(s)
Type :	fine bubbles	

Sludge recirculation

Type :	airlift	
Installed power :	-	kW
Power consumption :	-	kW
On / Off :	-	min.

Control panel

Type :	(option)
--------	----------

Legend

A	Primary settling compartment
B	Biological reactor
C	Secondary settling compartment
D	Bacterial support
E	Diffusers
F	Sludge recirculation
G	Settling cone
H	Ventilation

APPROVALS AND CERTIFICATES

CE	: EN 12566-3 CPD 89/106/CEE
BENOR	: CRT-009-KW

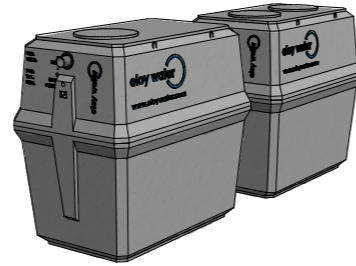

Sewage treatment / Oxyfix® C-90 MB 12 PE (1)

Sewage treatment / Oxyfix® C-90 MB 12 PE (1)

DIMENSIONS | VOLUMES | WEIGHTS

Measure	Unit	Tank 1	Tank 2
Total height* :	(cm)	225	225
Entry height* :	(cm)	200	200
Exit height* :	(cm)	198	198
Length :	(cm)	238	238
Width :	(cm)	158	158
Total volume :	(m ³)	6.00	6.00
Useful volume :	(m ³)	5.20	5.20
Weight :	(T)	2.75	3.34
Weight (w/o shipping cover):	(T)	2.73	3.29
Manhole(s) :	(cm)	1 x Ø60	2 x Ø60
Ø In / Out :	(mm)	110/110	110/110

* tolerance ± 2 cm

Material

Tank(s):	High performance steel reinforced concrete
Biocarrier:	Recycled PP
Air feed pipes:	PVC PN16



TANK DIMENSIONS

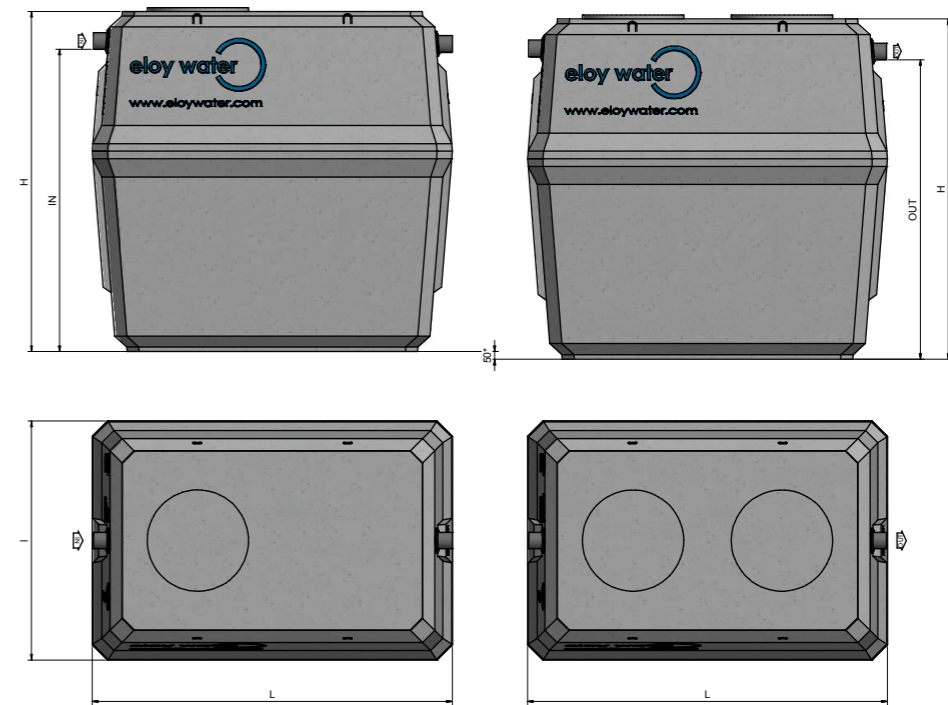

OPERATION

Useful volumes/surfaces

Primary settling compartment:	5.20	m ³
Biological reactor:	2.92	m ³
Clarifier:	1.08	m ²

Operation

Sampling chamber:	integrated
Theoretical desludging frequency:	every 33 months
Approximate energy consumption:	700 kW
Maintenance frequency :	annually (recommended)
Admissible load :	80 cm of fill + pedestrian load

Consumables

Blower filter:	annually
Blower membranes:	every 2 years
Air diffusers:	every 8 years

OPTIONS

Wall support for blower	
PE/concrete tank cover riser	3 pcs
PE/steel tank cover	3 pcs

GUARANTEES

Electromechanical kit :	2+1 years
Tanks :	10+5 years
Resistance :	B125